

Map referred to in The Leeds City Council (East Leeds Orbital Road) Compulsory Purchase Order 2018 - General Vesting Declaration

THE COMMON SEAL OF
LEEDS CITY COUNCIL
was hereunto affixed in
the presence of :-
Philippa Plumtree-Varley
Philippa Plumtree-Varley
Development Team Leader
Authorised Officer
Dated... 10. October 2019

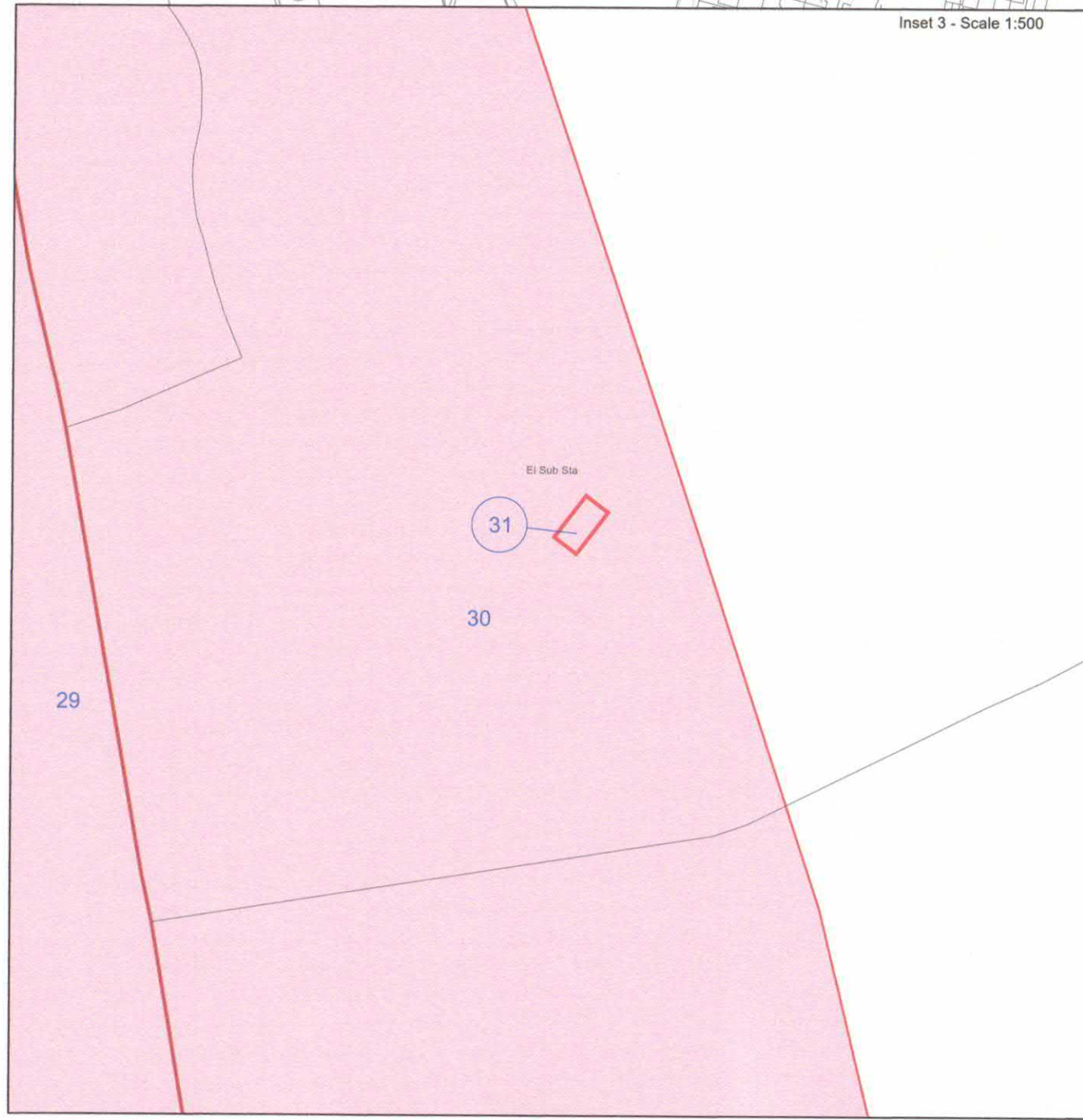
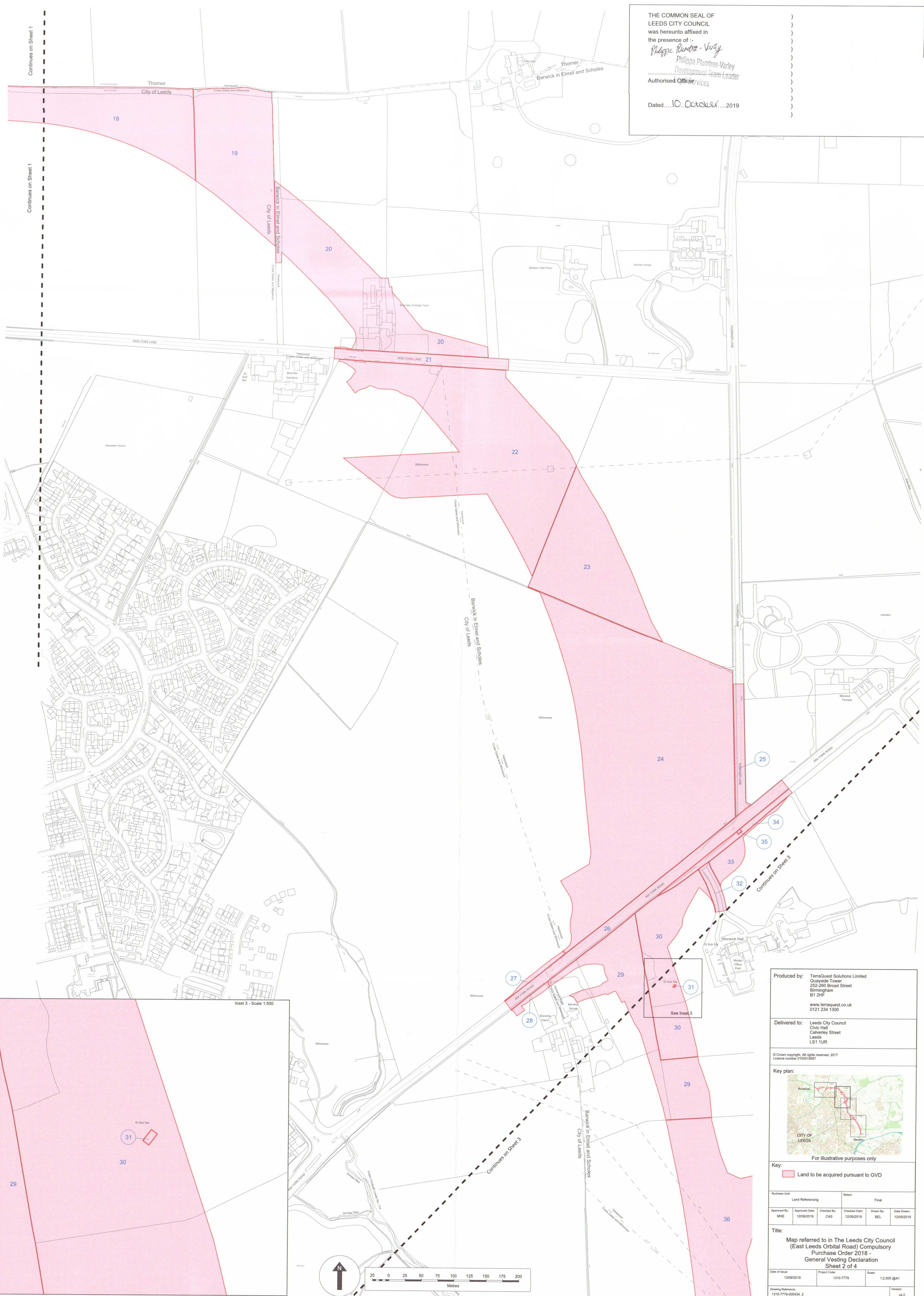

Produced by: TerraQuest Solutions Limited
Quayside Tower
252-260 Broad Street
Birmingham
B1 2HF
www.terraquest.co.uk
0121 234 1300

Delivered to: Leeds City Council
Civic Hall
Calverley Street
Leeds
LS1 1UR

© Crown copyright. All rights reserved. 2017
Licence number: 0100019567

Key plan:

For illustrative purposes only

Key:
Land to be acquired pursuant to GVD

Business Unit	Land Referencing	Status	Final
Approved By:	MHE	Approved Date:	12/09/2019
Checked By:	CAS	Checked Date:	12/09/2019
Drawn By:	BEL	Date Drawn:	12/09/2019

Title:
Map referred to in The Leeds City Council
(East Leeds Orbital Road) Compulsory
Purchase Order 2018 -
General Vesting Declaration
Sheet 2 of 4

Date of issue:	13/09/2019	Project Code:	1316-7778	Scale:	1:2,500 @A1
Drawing Reference:	1316-7778-000434_2	Version:	v4.0		

